

ID15310

Miscelatore monocomando per doccia esterno, interasse 150 mm. Vitoni ceramici, portata 12 l/min. Raccordo 1/2".

External single lever shower mixer, 150 mm interaxes. Ceramic valves, 12 l/min flow rate. 1/2" connection.

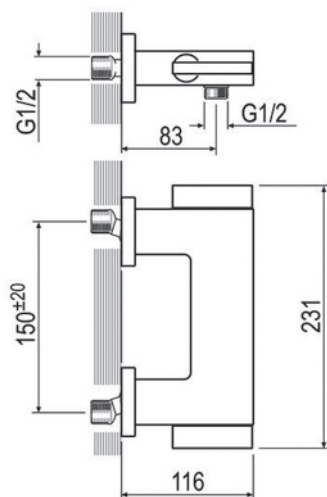
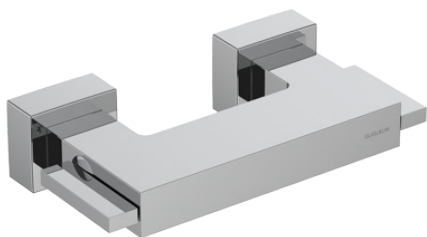

CERTIFICAZIONI PRODOTTO PRODUCT APPROVALS

L'articolo può disporre di alcune di queste certificazioni. The article may have some of these approvals.



IMBALLI E RICICLABILITÀ PACKAGING AND RECYCLING

| SCATOLA BOX         | VOLUME VOLUME        | TARA TARE     | PESO LORDO GROSS WEIGHT              |
|---------------------|----------------------|---------------|--------------------------------------|
| 13 x 23,5 x 30,5 cm | 0,009 m <sup>3</sup> | 0,35 kg       | 5,5 kg                               |
| COLLO MC            | VOLUME VOLUME        | TARA TARE     | N° SCATOLE PER COLLO N° BOXES FOR MC |
| 38 x 40 x 40 cm     | 0,061 m <sup>3</sup> | 0,9 kg        | 4                                    |
| PLASTICA PLASTIC    | CARTA PAPER          | PALLET PALLET | N° COLLI PER PALLET N° MC FOR PALLET |
| 0,002 kg            | 0,575 kg             | 9 kg          | 18                                   |

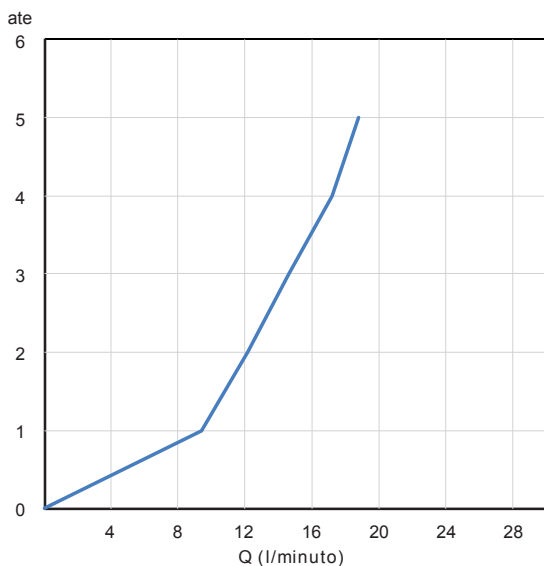

DIAGRAMMA DI PORTATA FLOW RATE DIAGRAM

Test eseguito secondo le norme europee EN 817 - EN 200. Portata calcolata con l'impiego di aeratori certificati.

Test carried out according to the European standards EN 817 - EN 200. Flow rate calculated by the application of certified aerators.

| ate       | 1   | 2    | 3    | 4    | 5    |
|-----------|-----|------|------|------|------|
| Q (l/min) | 8,7 | 12,1 | 14,8 | 17,0 | 19,0 |