

GE15160

Miscelatore monocomando per doccia esterno, interasse 150 mm. Cartuccia ceramica, portata 12 l/min. Raccordo 1/2".

External single lever shower mixer, 150 mm interaxes. Ceramic cartridge, 12 l/min flow rate. 1/2" connection.

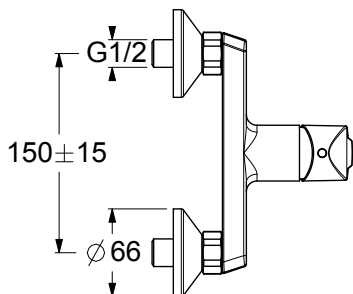
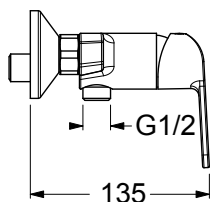

CERTIFICAZIONI PRODOTTO PRODUCT APPROVALS

L'articolo può disporre di alcune di queste certificazioni. The article may have some of these approvals.



IMBALLI E RICICLABILITÀ PACKAGING AND RECYCLING

| SCATOLA BOX | VOLUME VOLUME | TARA TARE | PESO LORDO GROSS WEIGHT |
|------------------|----------------------|---------------|--------------------------------------|
| 11 x 10 x 18 cm | 0,002 m ³ | 0,13 kg | 1,23 kg |
| COLLO MC | VOLUME VOLUME | TARA TARE | N° SCATOLE PER COLLO N° BOXES FOR MC |
| 38 x 40 x 40 cm | 0,061 m ³ | 0,88 kg | 20 |
| PLASTICA PLASTIC | CARTA PAPER | PALLET PALLET | N° COLLI PER PALLET N° MC FOR PALLET |
| 0,002 kg | 0,174 kg | 9 kg | 18 |

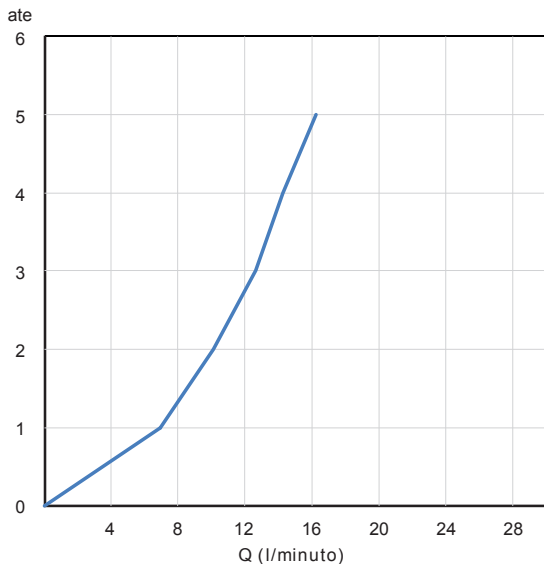

DIAGRAMMA DI PORTATA FLOW RATE DIAGRAM

Test eseguito secondo le norme europee EN 817 - EN 200. Portata calcolata con l'impiego di aeratori certificati.

Test carried out according to the European standards EN 817 - EN 200. Flow rate calculated by the application of certified aerators.

| ate | 1 | 2 | 3 | 4 | 5 |
|-----------|-----|------|------|------|------|
| Q (l/min) | 7,3 | 10,6 | 12,6 | 14,5 | 16,2 |